

# Seal + Cut 4-in-1 System User Guide



Set-up Video

919-247-0328

Contact@vetovation.com



Procedure Video

**Before using your system, please reach out to us at Contact@vetovation.com or call us at 919-247-0328 to schedule a 20-minute virtual training session. If you would like to practice using the system prior to a case, we have found that using thin steak provides the most realistic results.**

**01** Scan To Watch Set-up Video



**02** Scan To Watch Procedure Video



**Please call 919-247-0328 or email us at Contact@vetovation.com if you have any questions.**

# COMPONENTS

01	Disposable Smoke Evacuation Tubing With Pencil Adapter	VES-ESU-00808
02	Disposable Smoke Evacuation Filter Tubing	VES-ESU-00809
03	Disposable Adhesive Grounding Plate	VES-ESU-02470
04	Reusable Grounding Plate	VES-ESU-00722
05	Autoclavable, Reusable Monopolar Pencil	VES-ESU-00438
06	Disposable Monopolar Pencil with Integrated Smoke Evacuator Tubing	VES-ESU-02476
07	Disposable Monopolar Pencil	VES-ESU-00759.1
08	Disposable Monopolar Pencil, Stainless Steel Tip	VES-ESU-00758.2
09	Pack of 10 Assorted Electrode Tips	VES-ESU-00444
10	Autoclavable, Reusable Bipolar Forceps 2mm	VES-ESU-01410
11	Autoclavable, Reusable Bipolar Forceps Cable	VES-ESU-01411
12	Autoclavable, Reusable Vessel Sealing Handpiece + Cable	VES-ESU-02557.1
13	Autoclavable, Reusable Smoke Evacuator Tubing	VES-ESU-01622
14	Waterproof Foot Pedal	VES-ESU-00439
15	20 Hour Smoke Evacuation Filter	VES-ESU-00810

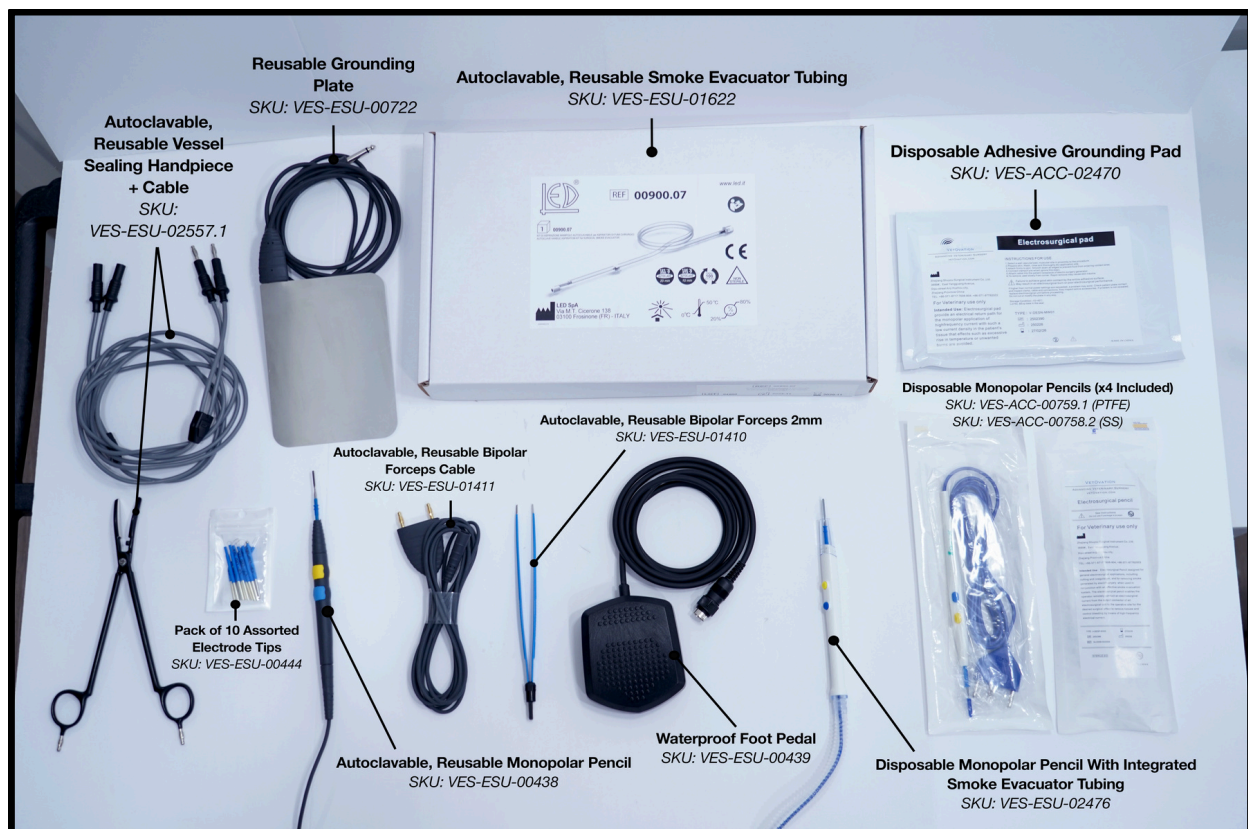

# START UP

**Ensure that you start operating with the surgical settings shown below.**



**If using the vessel sealing handpiece, you will need to plug in and use the foot pedal to activate the energy.**

*If you have any questions regarding specific Cut and/or Coagulation settings, please refer to the manufacturer's User Manual, page 31. This will give you a detailed description of each setting option.*

# ELECTROSURGERY TIPS & TRICKS

## Monopolar Energy:

When using your grounding plate, you will want the best contact with your patient's skin as possible. If you do not have solid contact, this can result in poor Cut/Coag effects. You can try two things to ensure quality contact:

- 01 Place ultrasound gel directly onto the grounding pad, which should penetrate through the patient's fur, giving good skin contact - this should always be used during longer cases.
- 02 Soak a towel in water and wrap the towel around the grounding pad - this should only be used for shorter cases as the water will start to evaporate.

## Vessel Sealing:

- ▶ When using your bipolar vessel sealing handpiece, first ensure that your foot pedal is plugged into the generator. You have to use the foot pedal to activate the energy. If there is an "X" across the foot pedal icon located at the bottom right of the screen, simply click the icon to remove the "X", enabling you to use the foot pedal.
- ▶ You will want to select "Sealing Stop" under your bipolar vessel sealing settings. This will enable the unit to stop delivering energy to the handpiece when it senses the tissue is coagulated.
- ▶ If you wish to coagulate a vessel more than once, this is okay. To do this properly, after the first seal is complete, you will want to overlap the first seal by 50% with the jaws before starting a second seal.
- ▶ If you are vessel sealing and not receiving the tissue sealing effect desired, slowly release the jaws on the tissue you are coagulating, but do not fully release the tissue. If you squeeze too hard onto the tissue, this can occasionally result in a poor seal. If this does not work, you can slowly increase the coagulation wattage on your generator screen.

# CLEANING & MAINTENANCE

## 01

### Electrode Tips

Over time, your electrode tips will start to collect black carbon buildup. You can scrub this off using a Brillo pad if needed. Eventually after multiple uses, they will simply need to be replaced. These are autoclavable.

## 02

### Vessel Sealing Handpiece(s)

Vessel Sealing Handpiece jaws will need to be scrubbed thoroughly, ensuring they are free of any tissue buildup prior to autoclaving the handpiece. Please use a sponge/Brillo pad and any enzymatic cleaning solution to clean the handpiece.

## All Items Below Can Be Steam Autoclaved:

***Vessel Sealing Handpiece & Cable***

***Reusable Steel Grounding Plate & Cable***

***Bipolar Forceps & Cable***

***Black Monopolar Pencil & Cable***

***Electrode Tips***

***Autoclavable Smoke Evacuator Tubing***

**If you have any questions,  
please feel free to contact us  
at Contact@vetovation.com  
or call 1-844-255-7297.**

**We are happy to schedule a call to walk you  
through the setup, usage, and maintenance of  
the equipment.**